



## 2 Abbey Apartments Charlton Road, Bristol, BS31 2JA

### Offers Over £125,000

Nestled in the heart of Keynsham, this charming one-bedroom apartment on Charlton Road offers a delightful blend of comfort and convenience. Spanning 441 square feet, the property is ideally situated just off the bustling High Street, providing easy access to a variety of local shops and amenities.

The apartment, built in 1960, has been thoughtfully designed to maximise space and light. It features an inviting open-plan living and kitchen area, perfect for both relaxation and entertaining. The uPVC double glazing ensures a warm and quiet environment, while the gas-fired central heating adds to the overall comfort of the home.

With Keynsham Train Station nearby, commuting to Bristol and Bath is a breeze, making this property an excellent choice for professionals or anyone seeking a vibrant community lifestyle. Additionally, the absence of an onward sales chain simplifies the buying process, allowing for a smoother transition into your new home.

This apartment presents a wonderful opportunity for first-time buyers, investors or those looking to downsize, combining modern living with the charm of a well-established area. Don't miss the chance to make this delightful property your own.

Entrance via front door into

### Hallway

Storage cupboard with fitted shelving, doors to

### Bathroom

6'2" x 5'10" (1.89 x 1.80)



Suite comprising panelled bath with shower attachment over, close coupled w/c, pedestal wash hand basin with mixer taps, double radiator, extractor fan.

### Bedroom

9'10" x 7'10" (3.02 x 2.41)



uPVC double glazed window to front aspect, single radiator, cupboard housing Worcester combination boiler.

### Open Plan Kitchen/Living Room

19'9" x 10'8" (6.04 x 3.26)



Three uPVC double glazed windows to front aspect, a range of wall and floor units with worksurface over, sink drainer unit with mixer taps over, integrated gas hob, integrated oven, space for fridge freezer, double radiator.

### Directions

Sat Nav BS31 2JA

## Floor Plan

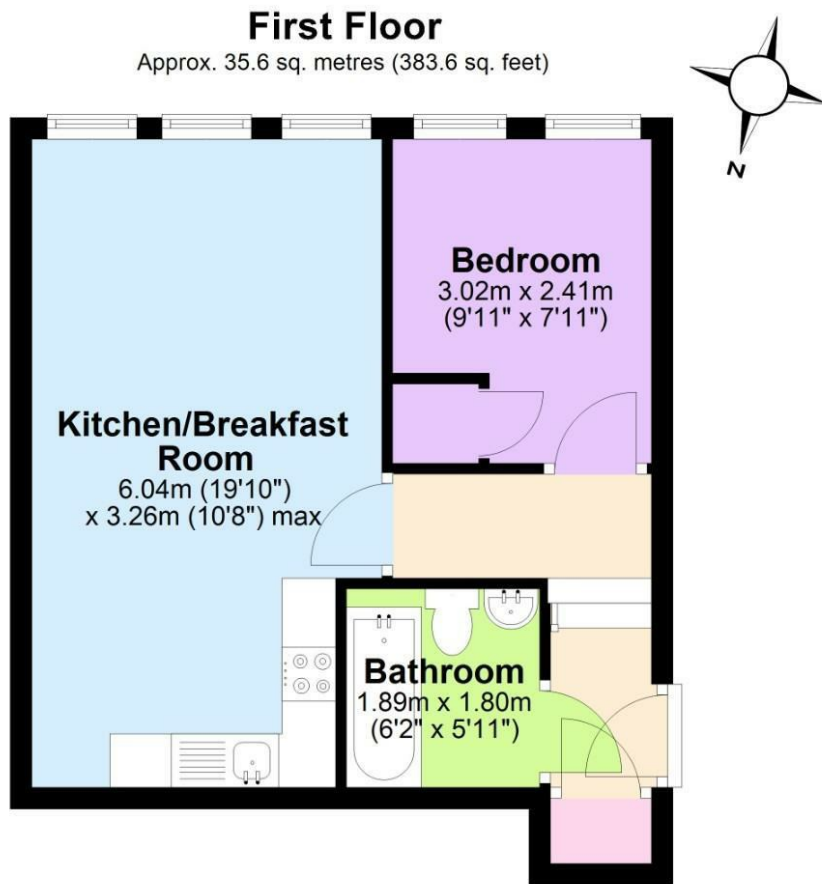

Total area: approx. 35.6 sq. metres (383.6 sq. feet)  
**2 Abbey Apartments, Keynsham**

## Area Map

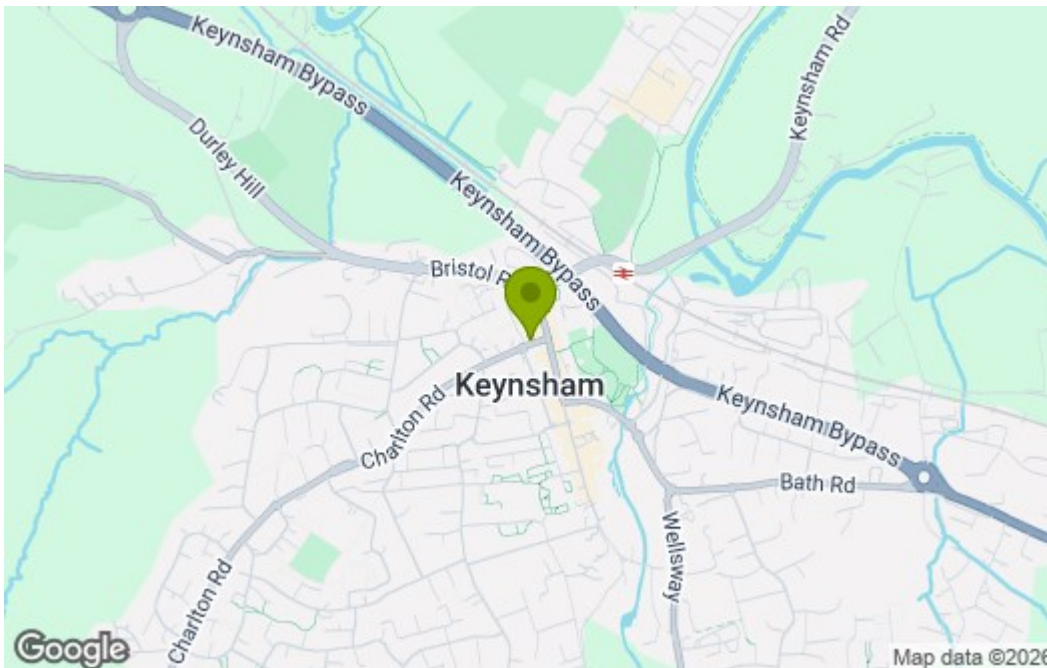

## Energy Efficiency Graph

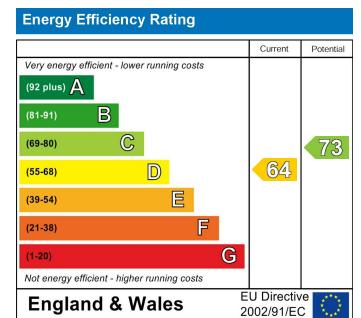

These particulars, whilst believed to be accurate are set out as a general outline only for guidance and do not constitute any part of an offer or contract. Intending purchasers should not rely on them as statements of representation of fact, but must satisfy themselves by inspection or otherwise as to their accuracy. No person in this firm's employment has the authority to make or give any representation or warranty in respect of the property.